

File 13 Slide 346

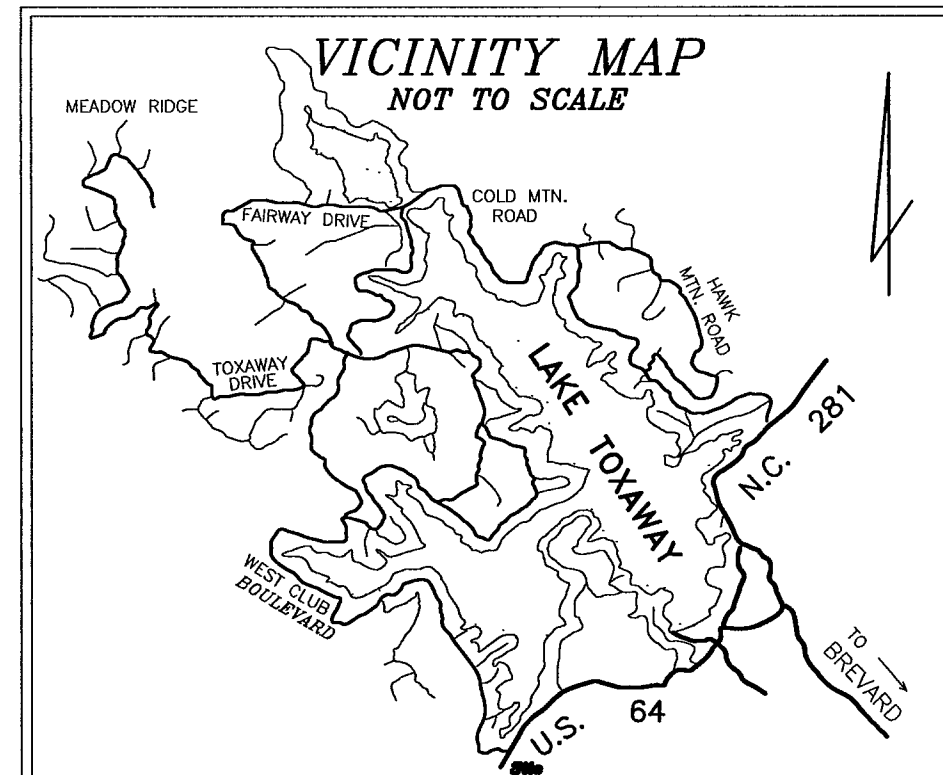
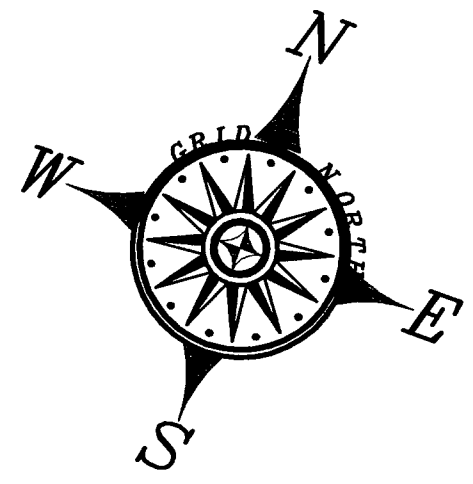

LEGEND

- POB = POINT OF BEGINNING
- ⊙ = CONC. MON. FND.
- EIP = EXIST. IRON PIN
- P— = PROPERTY LINE
- R/W = RIGHT OF WAY
- X- = FENCE
- ⊕ = UTILITY POLE
- P- = POWER LINE
- P-T- = POWER & TELEPHONE
- NIP = NEW IRON PIN
- △ = P.K. NAIL SET
- ⊠ = CONC. MON. SET.
- B— = BUILDING LINE
- C— = CENTER LINE
- = COMPUTED POINT
- = NEW IRON PINS.
- C.C. = CONTROL CORNERS.
- + = POINTS

WITH OUTSIDE BOUNDARY

COURSE	BEARING	DISTANCE
5-6	S 25°07'45"E	101.30'
6-6A	S 76°22'10"E	79.95'
6A-6B	N 58°15'30"E	50.05'
6B-6C	N 80°33'35"E	124.15'
6C-9	S 10°22'20"E	10.00'
9-10	S 08°09'00"W	88.30'
10-11	S 12°47'00"W	176.13'
11-12	S 00°59'20"E	62.59'
12-13	S 12°35'20"W	160.27'
13-14	S 58°36'00"W	63.37'
14-15	S 65°46'55"W	136.64'
15-16	S 53°30'30"W	96.51'
16-17	S 42°06'05"W	89.08'
17-18	S 58°10'00"W	111.13'
18-19	S 73°28'10"W	75.50'
19-20	S 88°55'45"W	103.25'
20-21	S 67°30'55"W	85.98'
21-22	S 33°28'55"W	153.54'
22-23	S 44°02'35"W	109.04'
23-24	S 43°10'15"W	119.62'
24-25	N 23°56'30"E	1012.66'
25-26	N 06°51'45"E	182.86'
26-27	N 82°36'35"E	152.44'
27-28	N 05°36'45"E	605.20'
28-29	S 12°50'30"E	74.10'
29-30	S 05°39'00"E	53.90'
30-31	S 00°42'45"E	44.29'
31-32	S 01°57'55"W	185.91'
32-33	S 01°45'20"W	48.26'
33-34	S 00°15'50"E	37.96'
34-35	S 07°46'50"E	40.48'
35-36	S 24°30'10"E	40.66'
36-37	S 48°37'00"E	43.20'
37-38	S 69°40'25"E	42.21'
38-39	S 77°29'55"E	33.39'
39-40	S 81°17'35"E	78.86'
40-41	S 85°08'20"E	39.87'
41-42	N 86°31'16"E	43.37'
42-43	N 71°35'05"E	42.07'
43-5	N 59°40'00"E	25.95'

D.W. CASH  
97-7739  
247/114

J.A. FISHER III  
08-2350  
313/490

GORGES STATE PARK  
447/580

GORGES AT LAKE TOXAWAY LLC  
447/106  
07-8351

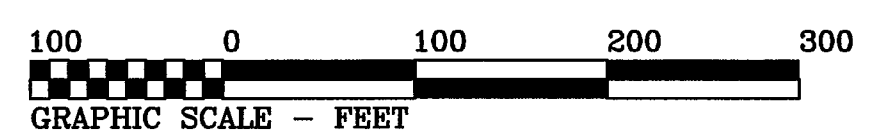

I, WOODROW W. WILSON, CERTIFY THAT THIS PLAT WAS DRAWN UNDER MY SUPERVISION (DEED DESCRIPTION RECORDED IN BOOK 259, PAGE 773, (ETC.) (OTHER); THAT THE BOUNDARIES NOT SURVEYED ARE CLEARLY INDICATED AS DRAWN FROM INFORMATION FOUND IN BOOK \_\_\_\_\_, PAGE \_\_\_\_\_, THAT THE RATIO OF PRECISION AS CALCULATED IS 1: 7500, THAT THIS PLAT WAS PREPARED IN ACCORDANCE WITH G.S. 47-30 AS AMENDED. WITNESS MY ORIGINAL SIGNATURE, REGISTRATION NUMBER AND SEAL THIS 31 DAY OF JULY, 2009.

*Woodrow W. Wilson*  
N.C. R.L.S. NO. L-1509



CONSERVATION EASEMENT  
06-9837  
P.F. 12, S.M. 565.

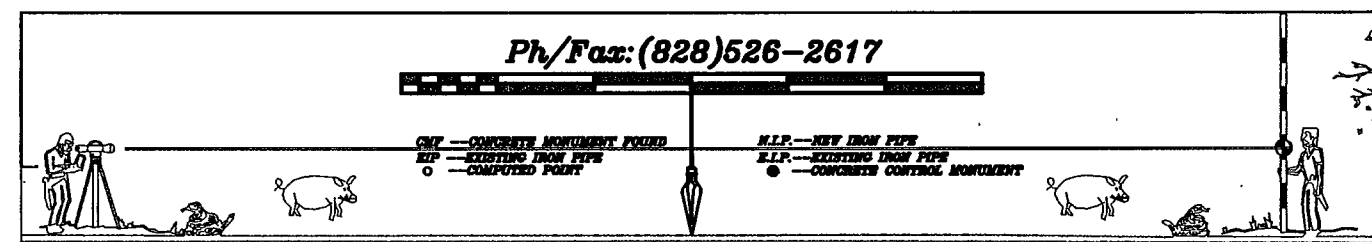

COURSE	BEARING	DISTANCE
A-B	S73°41'35"E	21.77'
B-C	S56°16'15"W	15.17'
C-D	S40°09'55"W	10.48'
D-E	S49°30'15"W	41.81'
E-F	S24°45'10"W	10.93'
F-G	N85°06'50"W	13.63'
G-H	N33°21'30"W	11.72'

- NOTES-
- THE PROPERTY IS LOCATED IN ZONE "X" PER F.E.M.A. FLOOD INSURANCE RATE MAP No. 37175CD165 C & 280 C.
  - THAT THE SURVEY IS OF AN EXISTING PARCEL OR PARCELS OF LAND AND DOES NOT CREATE A NEW ROAD OR CHANGE AN EXISTING STREET.
  - THIS PROPERTY IS SUBJECT TO ALL RIGHT-OF-WAY EASEMENTS AND RESTRICTIONS OF RECORD.
  - UNDERGROUND UTILITIES ALONG PRIVATE ROADS INSIDE BOUNDARY LINE.
  - FOUR OPEN MODEL SIGN'S INSIDE BOUNDARY AREA.
  - NUMBERS ALONG BOUNDARY LINE PER F.C.2, SLIDE: 290.
  - INTERIOR IMPROVEMENTS SHOWN ARE TAKEN FROM SURVEY PREPARED FOR TOXAWAY VIEWS, INC. BY WILLIAM LEONARD, DATED SEP. 14, 1982, RECORDED IN PLAT CAB. 2 SLIDE 290, TRANSYLVANIA COUNTY, N.C. RECORDS, AND ARE NOT FIELD VERIFIED BY THIS SURVEY.

STATE OF NORTH CAROLINA.  
COUNTY OF TRANSYLVANIA  
I, \_\_\_\_\_, REVIEW OFFICER OF \_\_\_\_\_ COUNTY, CERTIFY THAT THE MAP OR PLAT TO WHICH THIS CERTIFICATION IS AFFIXED MEETS ALL STATUTORY REQUIREMENTS FOR RECORDING.

DATE \_\_\_\_\_  
REVIEW OFFICER \_\_\_\_\_

NORTH CAROLINA, TRANSYLVANIA COUNTY.

THIS INSTRUMENT WAS RECORDED IN THIS OFFICE AT 2009007085

PLAT FILE: \_\_\_\_\_, SLID 12-21-2009 09:39:29 AM

CARD: \_\_\_\_\_

THIS \_\_\_\_\_ DAY \_\_\_\_\_

REGI. \_\_\_\_\_

TRANSLYLVANIA CO, NC FEE \$21.00  
PRESENTED & RECORDED:  
12-21-2009 09:39:29 AM  
CINDY M OWNBEE  
REGISTER OF DEEDS  
DEPUTY REGISTER OF DEEDS  
PF 13  
PG: 346-346

8521-07-3788-000

SURVEY FOR  
**TOXAWAY VIEWS INC.**

SCALE: 1"=100'  
DATE: 7/31/2009  
DRAWN BY: W.W.W. C.G.

COUNTY---TRANSYLVANIA  
TOWNSHIP---HOGBACK

WOODROW W. WILSON P.L.S. L-1509  
P.O. BOX 482  
HIGHLANDS N.C. 28741

DRAWING NUMBER  
T-2020